

## **Old Hall Estate**

**There follows a series of plans , which show the  
Estate at a variety of dates :**

**1907 , 1919 , 1925 , 1945 ;**

**the plots sold in 1971 and 1976 , on which Fine Garth Close  
and Firbeck Road were built ;**

**and notes of conveyances between 1975 and 1986.**

**1975 - 86 ,**

I by him & them from time  
 at all times wrap  
 will & pleasure to pass  
 on foot on valley  
 of land of yellow  
 clear so far as the  
 it be necessary for the  
 of the plantation  
 on the place  
 will right & liberty for the  
 of the land & all other  
 & the same being of the same  
 to be that changed & all  
 want & wants & all  
 house & land on them  
 to time & all times  
 have & this will &  
 & to pass & years with  
 house & land on the  
 of the land & of the  
 the land & the  
 wanted & of the  
 so far as the same is  
 way for the use  
 of the plantation  
 on the place

Old Hill Estate 1907

Reginald Wakfield 13 Dec 1907  
 1907

SEE SCHEDULES thereinbefore referred to.

No. on plan.	Description	Quantities ACRES
243	Capital messuage or dwellinghouse with out- buildings yards gardens and Orchards	1.892
242	Homestead and Garth sublet to John William Keuse	1.808
243	Two Cottages sublet to Mrs. Stockdale and William Buck	1.860
244	Garden Two Cottages sublet to Fred. Marriuer and Miss Simpson	.792
249	Plantation	.831
90	Plantation	.938
95	Croft	4.877
94	Plantation	.746
95	Far Bottom	1.877
123	Bottom	1.889
124	Croft Plantation	3.102
141	Plantation	3.166
142	Croft	4.824
143	Croft	6.390

Old Hill

Chesh View

attached to back of Chesh  
View & later developed.

Land and } The Grate Cottage

Old Hill Cottage

Old Hill Estate  
1907

1907

PLAN REFERRED

G. L. Fox Esq.

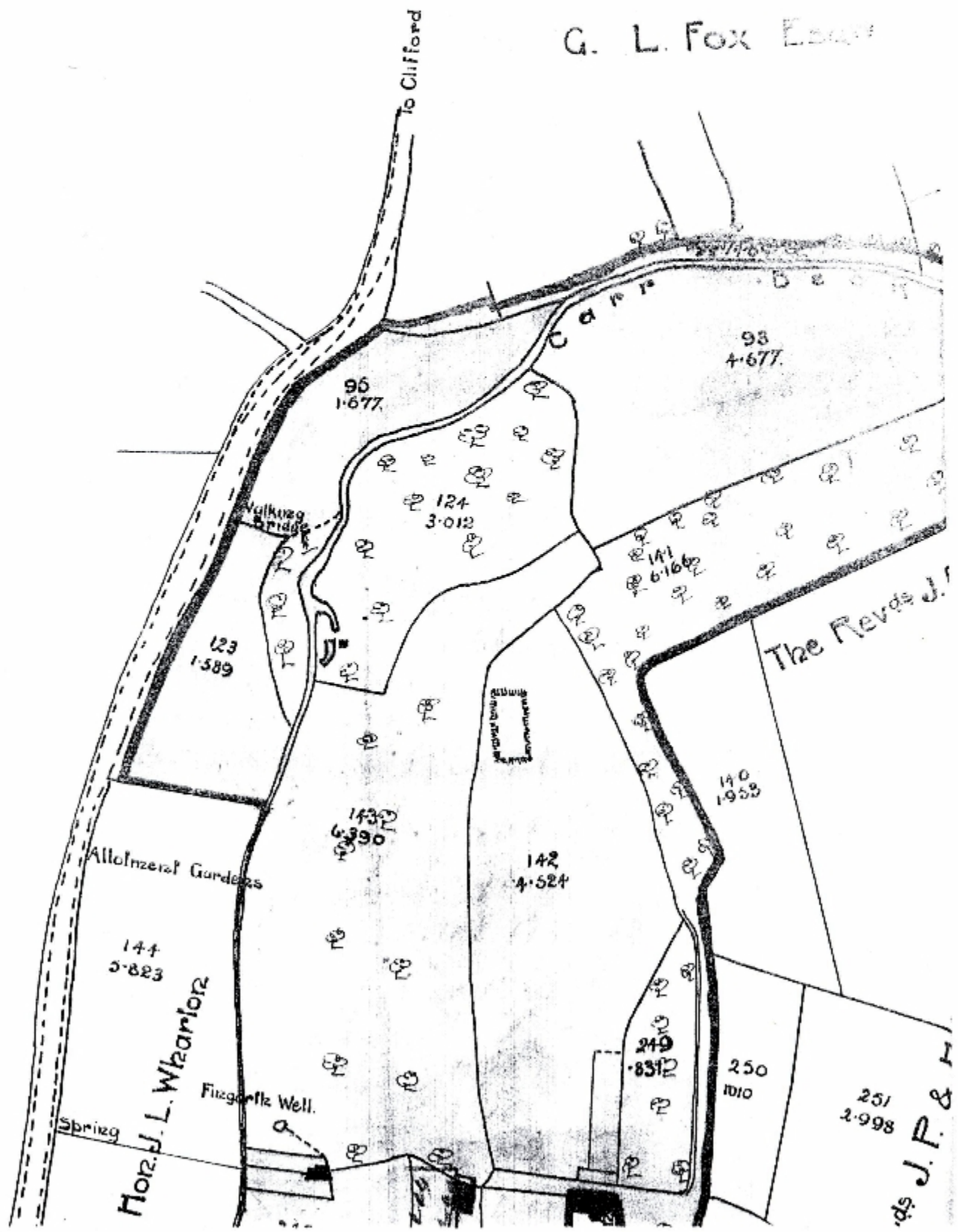

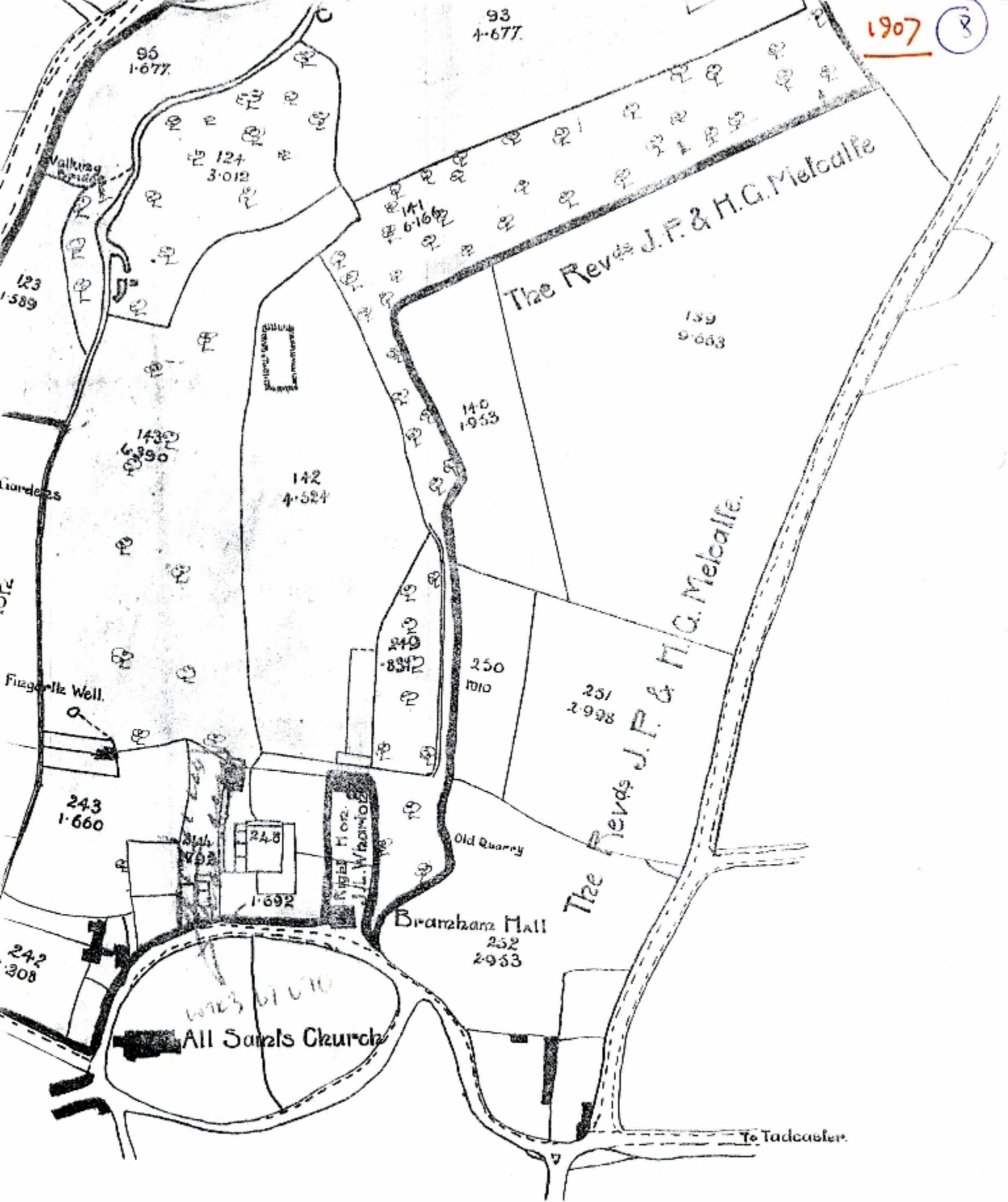

1907 (8)

— SCALE 1/2500. —

1907

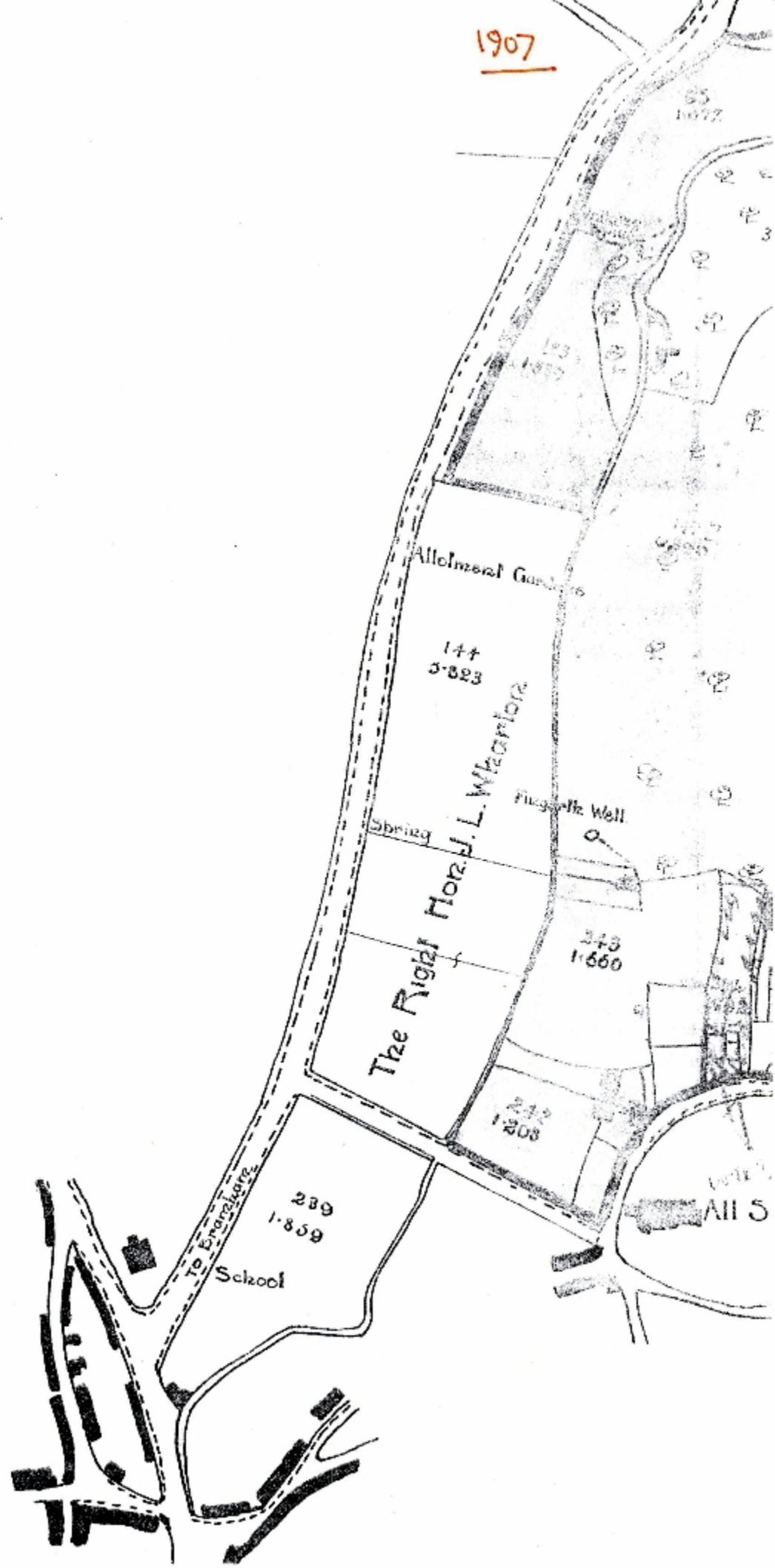

Allotment Garden

147  
3.823

The Right Hon. J. L. Whelan's

Spring

Fire-Brick Well

243  
1.660

242  
1.208

239  
1.859

To Enragakare

School

10/11  
A115

11

11

1907

PLA

to Clifford

G.

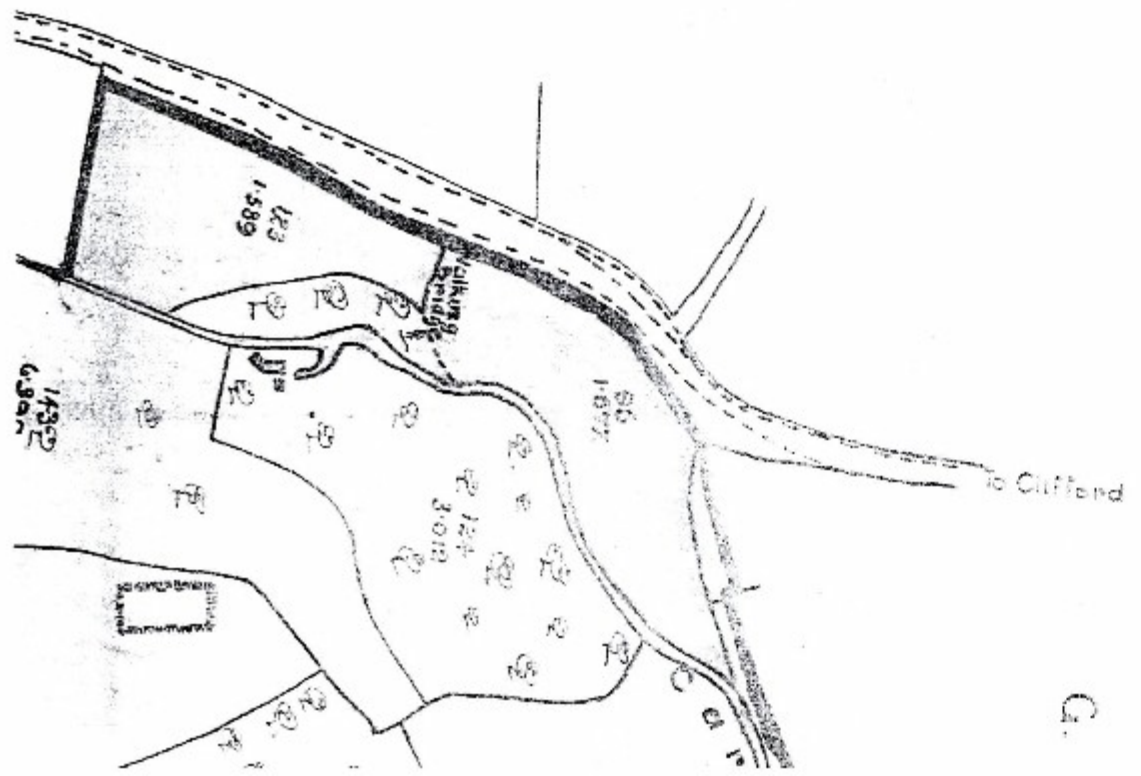

ED TO.

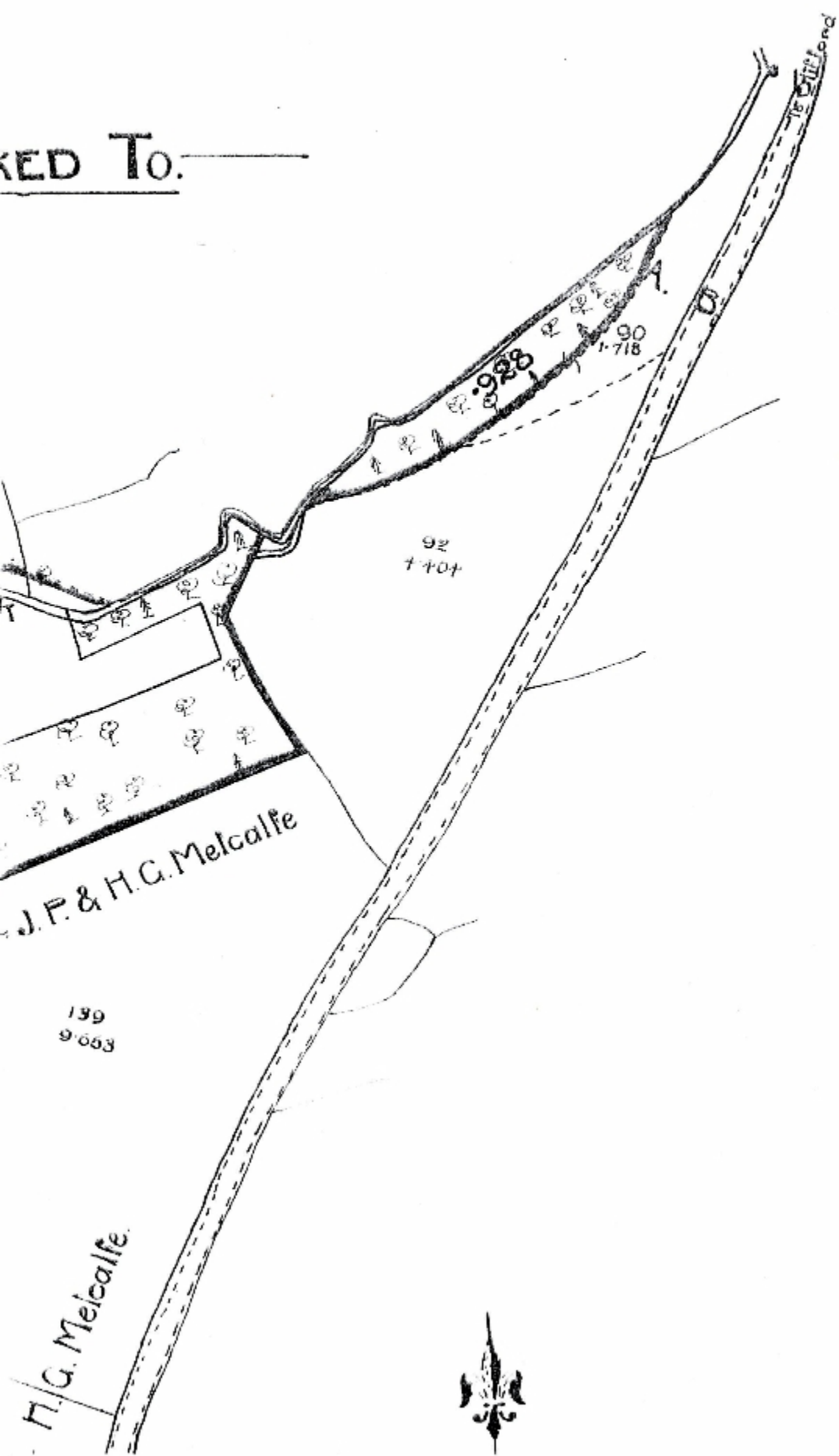

1919

1919

To Clifford.

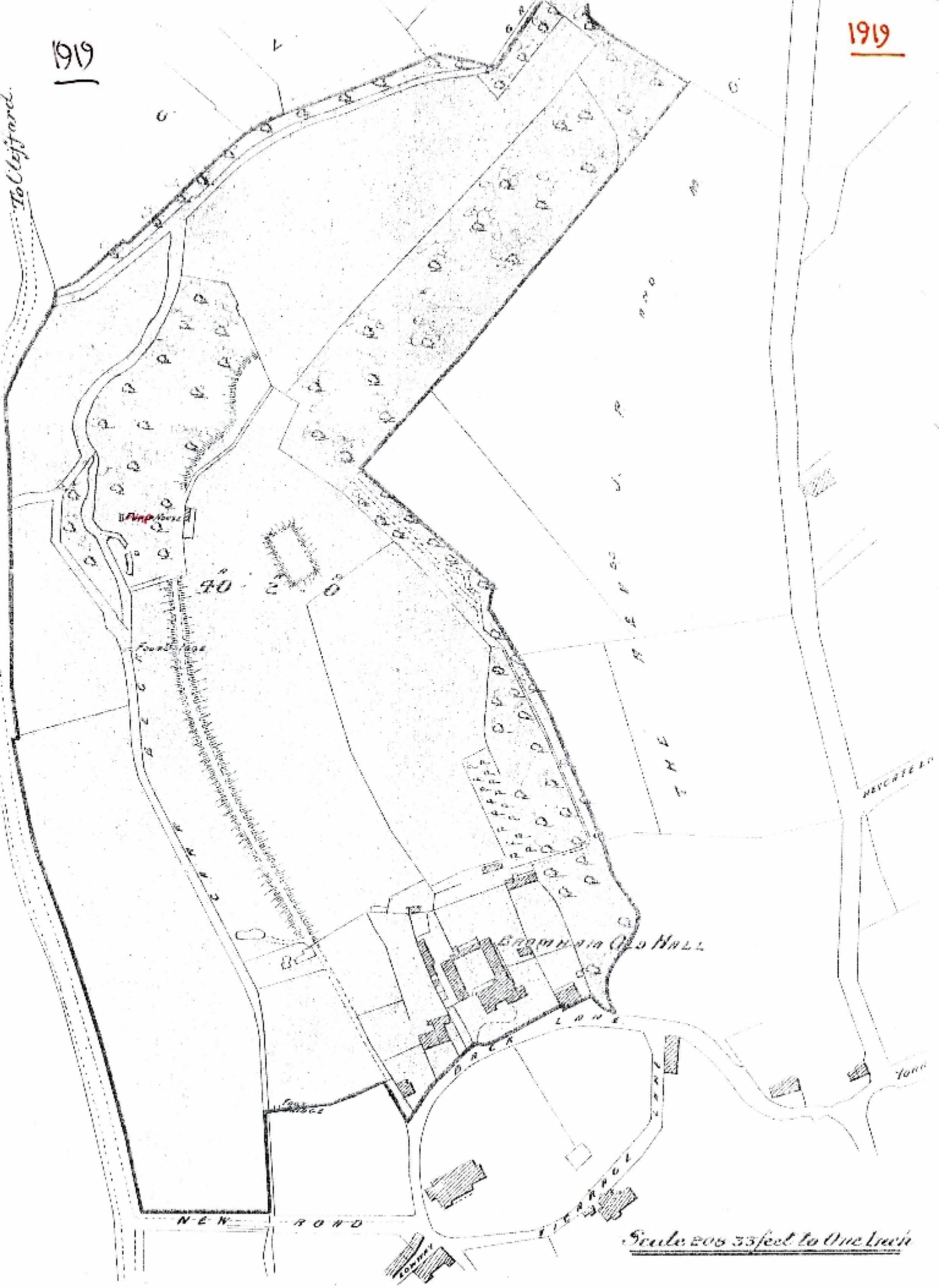

Scale 208 33 feet to One Inch



Old Hall Estate

as sold 1919

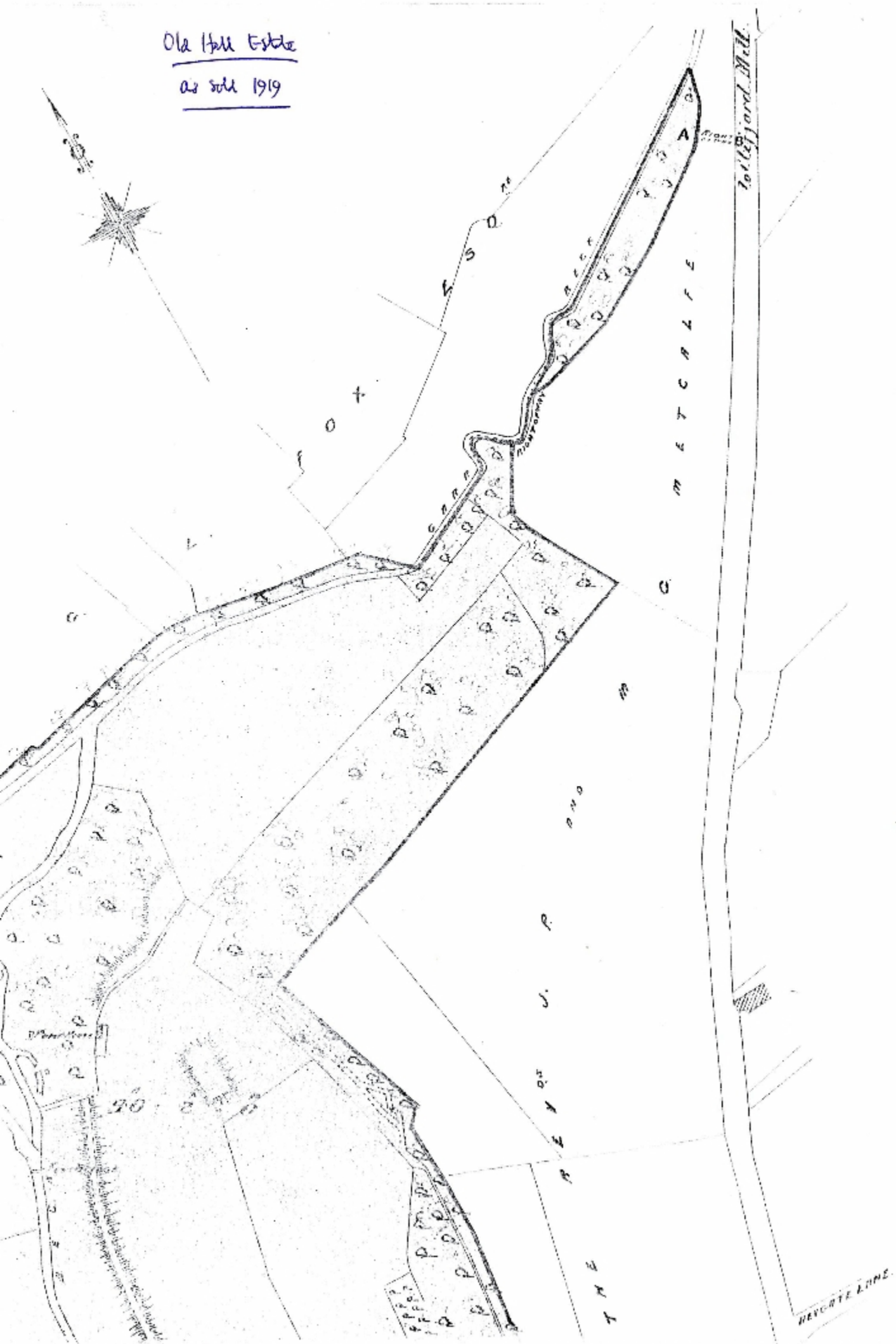

1925

*From Wetherby*

Old Hall Estate  
1925

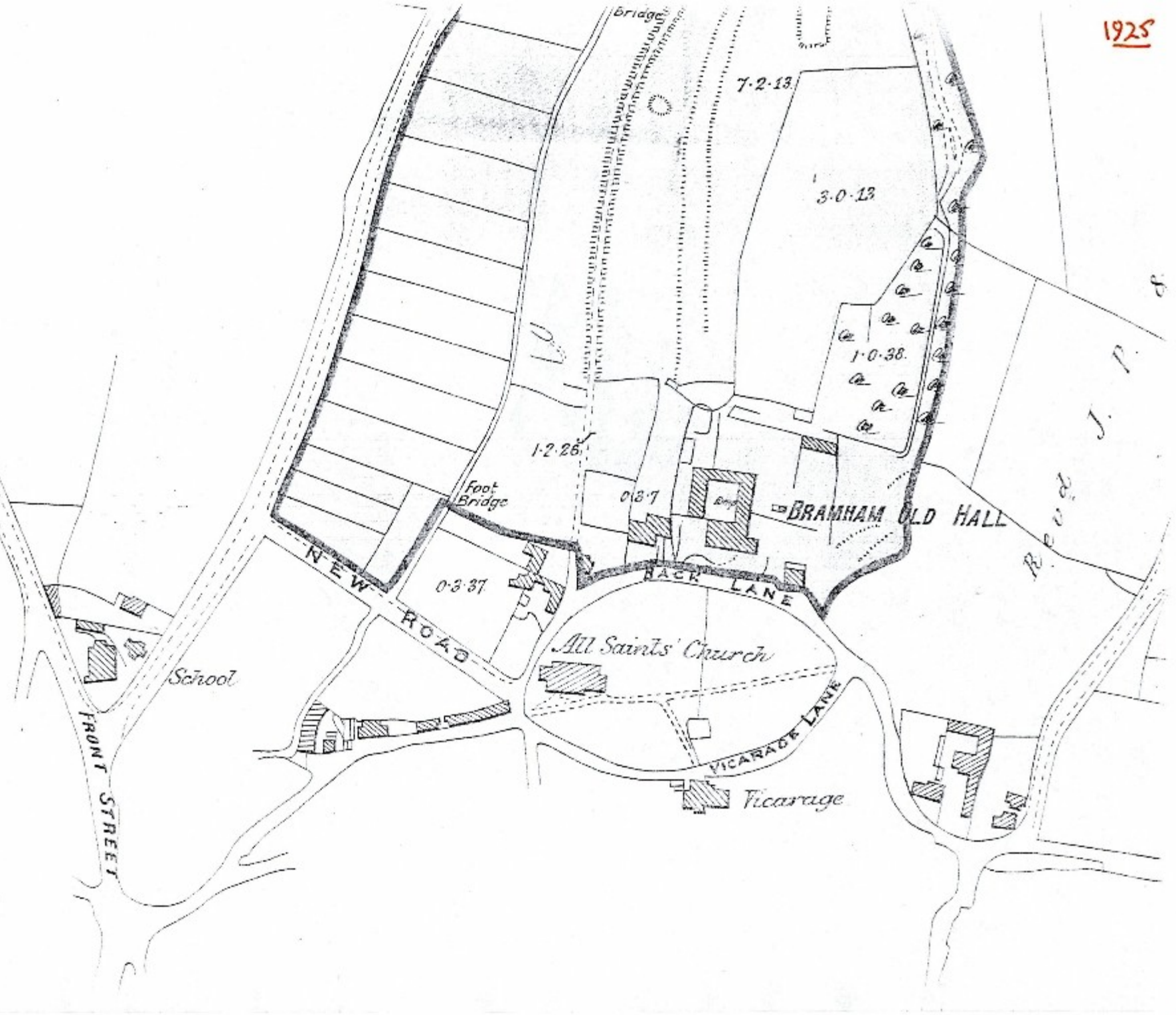

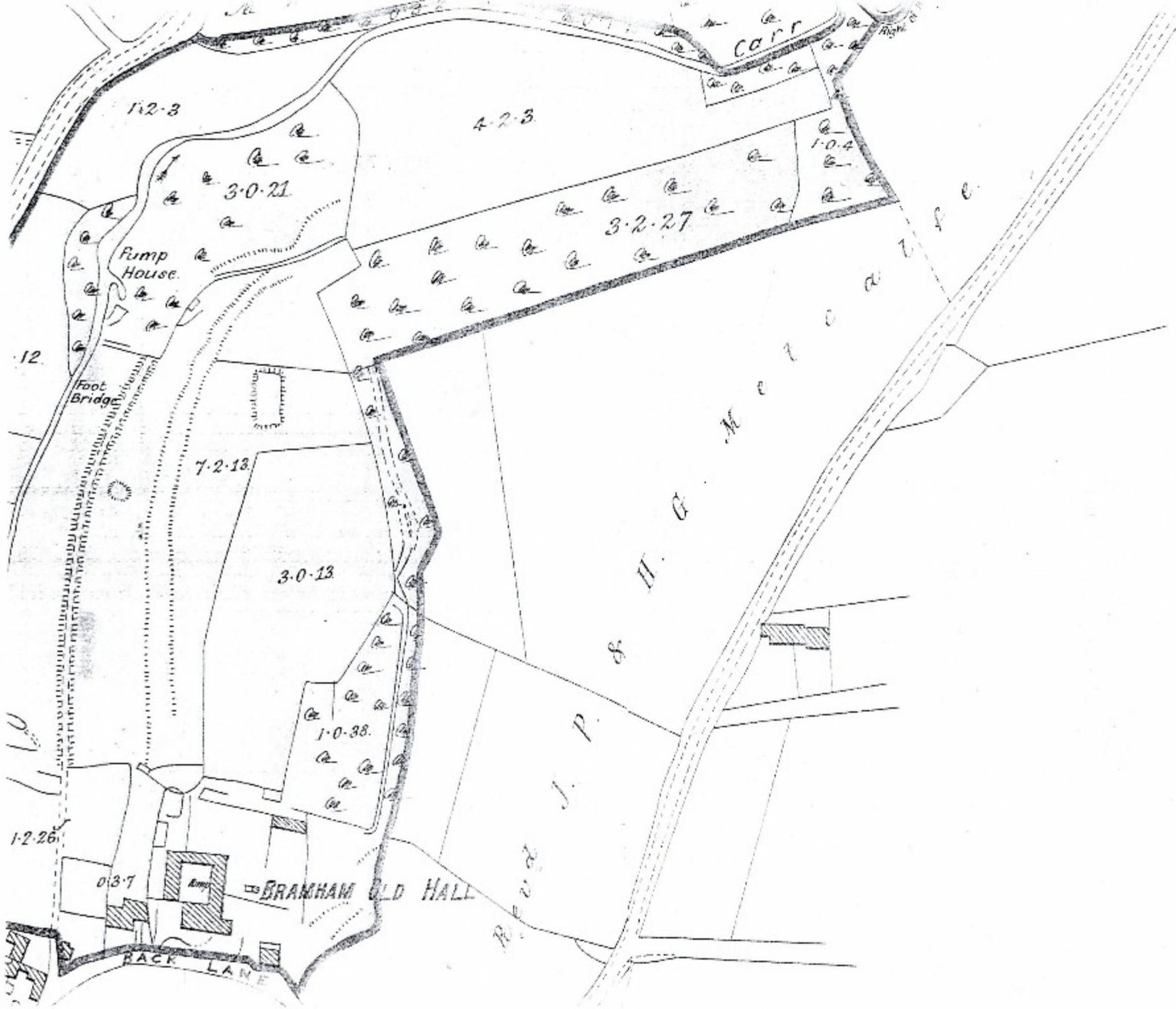

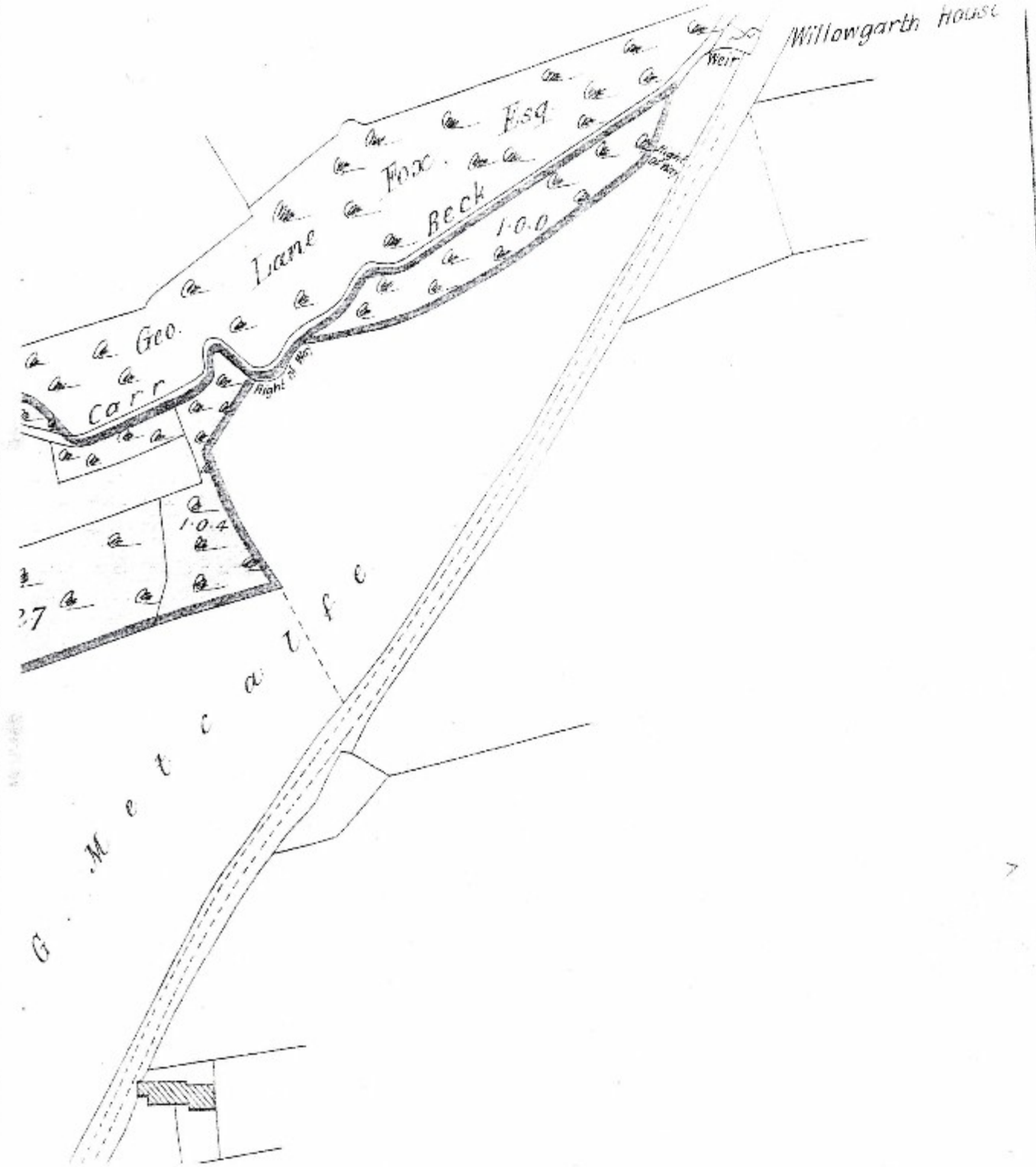

1945

Bromham

(Back Old Hill Estate marked)

96  
6868

1945

93  
4-531

Gallowhill Quarry  
(Disused)

Walking Bridge

Pump House

Reservoir

105  
A-827

144  
5-779

143  
7-526

142  
3-083

141  
1-602

140  
1-573

141  
1-200

250  
1-010

243  
1-660

244  
7-92

248  
1-164

Old Quarry

242  
1-208

252  
3-209

239  
1-859

All Saints' Church

(Vicarage)

Graveyard 247  
1-121

Vicarage

New Road

Carr Beck

HIGH STREET

SCALE: 1/2500

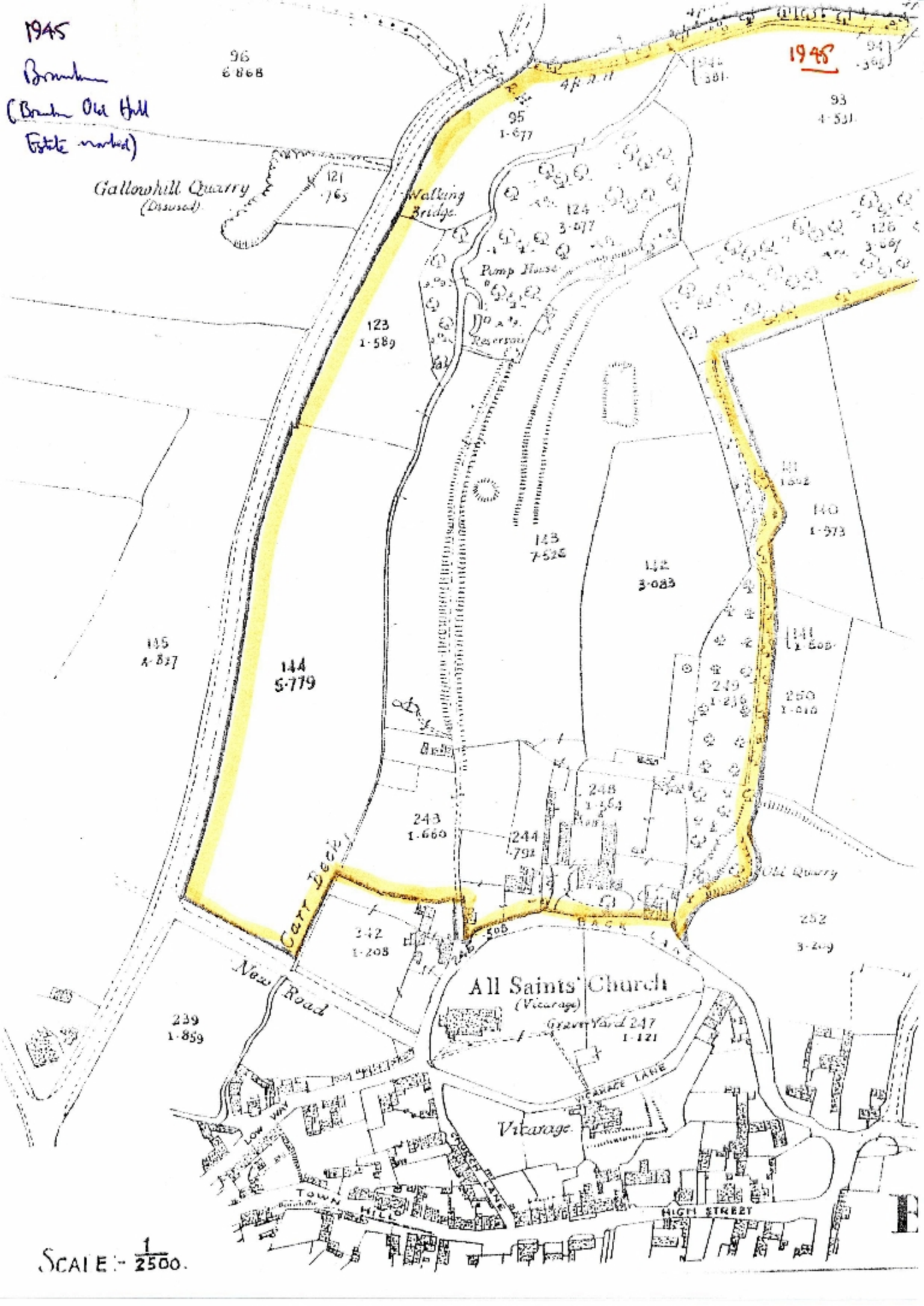

1945

92  
5-076

94  
-365

93  
4-531

128  
1-024

126  
3-607

141  
1-608

140  
1-973

141  
1-608

250  
1-010

Quarry

252  
5-209

Heygate Lane

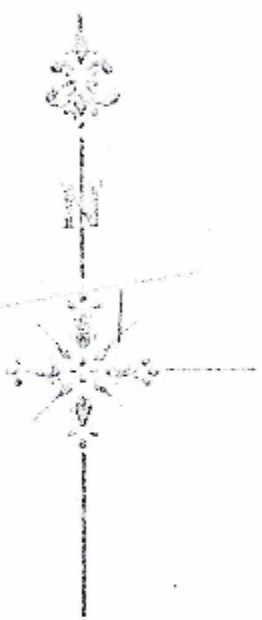

Map by J. ...

**Bramham**

1948

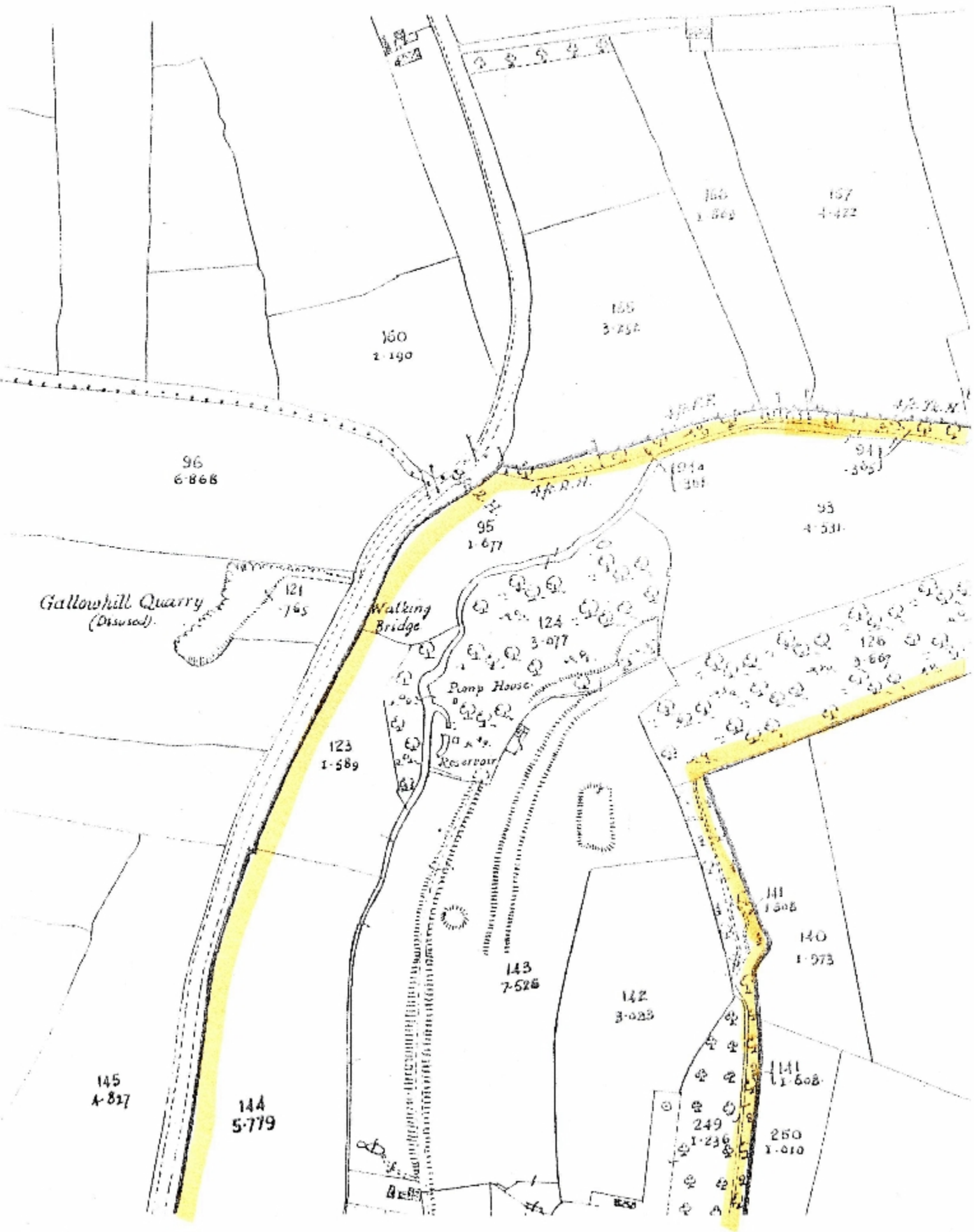

Bramham houses  
in 1945

1945

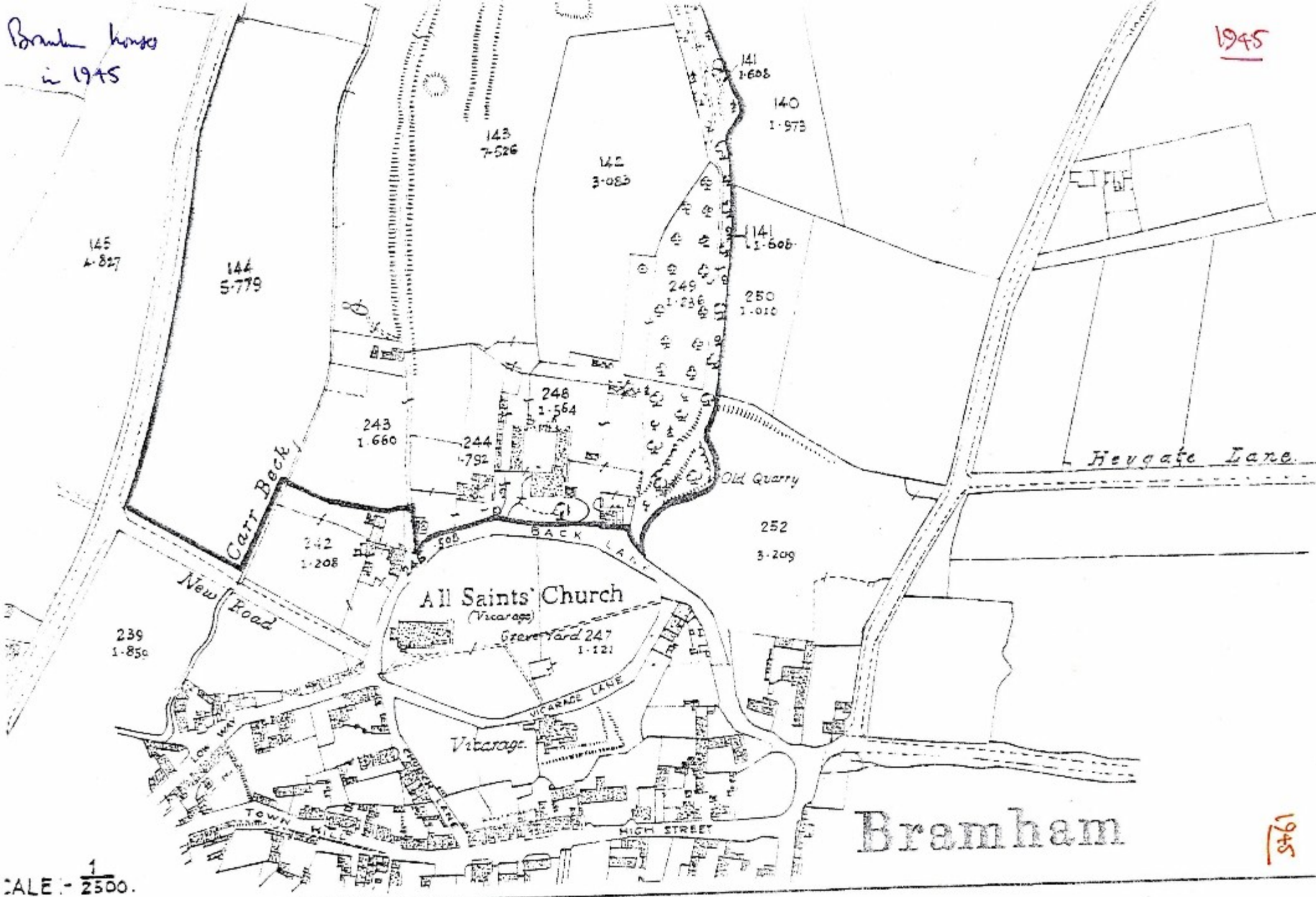

SCALE - 1/2500.

Bramham

1945



Sale of Plot on  
which Fishbark Rd (1)  
built to Ganching, etc.  
March 1971  
£ 19,000

Scale 1:1250  
for the purpose of identification only

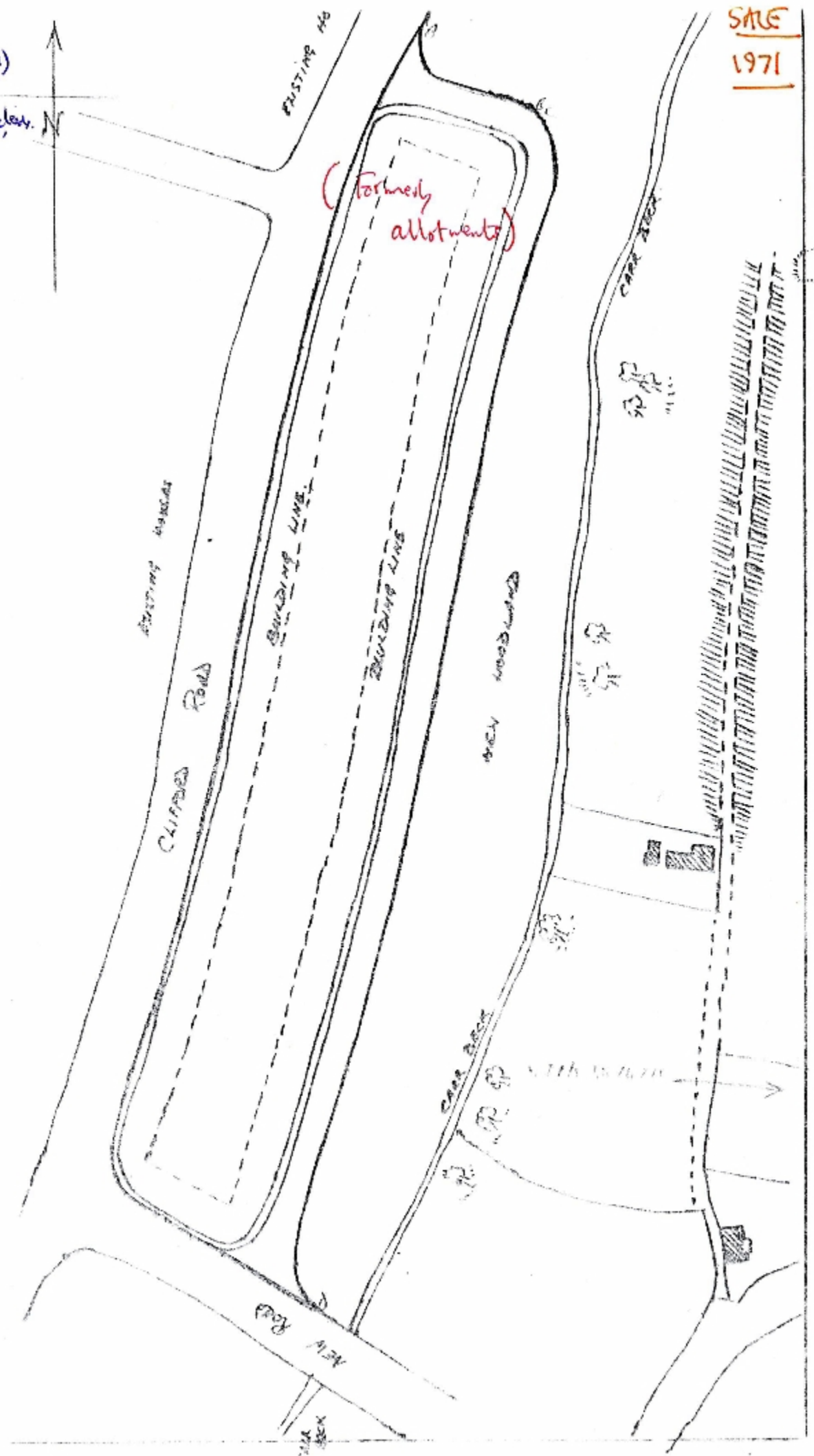

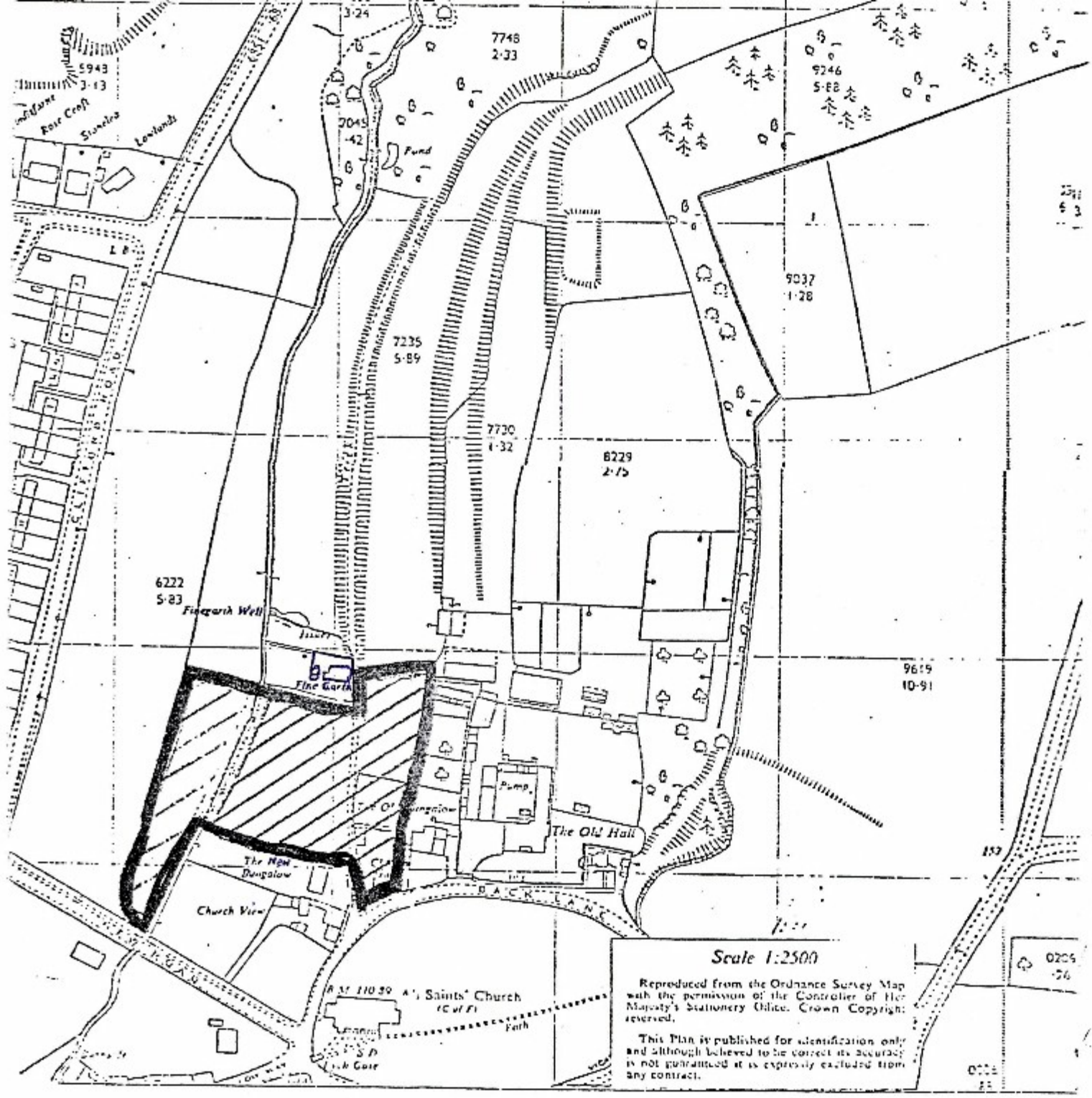

Plot sold by Old Hall  
 Estate to Buckley Homes  
 12 May 1976 for £24,000

Family Fine Garden,  
Robinson's Garden and strip  
 to W of Beck.

Used to build Fine Garden  
 Close (19 ), and  
 Fishbush Road (Phase 3) (1999)

SALE TO BUCKLEY  
 HOMES  
 1976

Scale 1:2500

Reproduced from the Ordnance Survey Map with the permission of the Controller of Her Majesty's Stationery Office. Crown Copyright reserved.

This Plan is published for identification only and although believed to be correct its accuracy is not guaranteed as it is expressly excluded from any contract.

RECEIVED  
- 5 DEC 1973  
H.M. INSPECTOR OF TAXES  
BRADFORD 4

H.M. INSPECTOR OF TAXES  
BRADFORD 4  
- 7 MAR 1974  
5th Floor, Britannia House,  
(Bridge St. Entrance)  
BRADFORD BD1 1LR  
103/10557/ES.

Sales made from land on Hill  
Estate 1975-86



£20,000

MEMORANDUM that by a Conveyance made the 16th day of September 1975 there was conveyed by the within named Ruth Whittingham and Roger Whitley Suddards the within named Executors unto Robert William Hills and Muriel Joyce Hills land comprising 12.841 acres at Tenter Hill Bramham for an estate in fee simple and an Acknowledgment was given for the production of and delivery of copies of the within written Grant

£57,200

MEMORANDUM that by a Conveyance dated the 1st day of March 1976 there was conveyed by the within named Ruth Whittingham and Roger Whitley Suddards the within named Executors unto The Leigh Mills Company Limited premises known as The Old Hall Bramham in the County of West Yorkshire for an estate in fee simple and an acknowledgment was given for the production of and delivery of copies of the within written Grant

£24,000

MEMORANDUM that by a Conveyance made the 12th day of May 1976 an irregular shaped plot of land fronting to Back Lane Bramham situate on the Westerly side of the Old Bungalow was conveyed to Auckley Homes Limited for an estate in fee simple and an acknowledgment was given for production of and delivery of copies of the within written Deed

£30,000

MEMORANDUM that by a Conveyance dated 12th June 1980 made between Ruth Whittingham and Roger Whitley Suddards (1) and Ian Leslie Westwood and Jennifer Elizabeth Hill (2) the dwellinghouse Fine Garth Bramham with the land thereto adjoining was conveyed for an estate in fee simple in possession and an acknowledgement was given for production of and delivery of copies of the within written Probate

MEMORANDUM that by a Conveyance dated 30th May 1986 made between Roger Whitley Suddards (1) and Anthony Ralph Cusens and Pauline Shirin Cusens (2) the freehold property situate and known as The Old Hall Cottage fronting Back Lane Bramham West Yorkshire was conveyed for an estate in fee simple in possession and an acknowledgment was given for production of and delivery of copies of the within written Probate

Extra Sales for Old Hall Estate (1) (Cooked to 1952 Conveyance)

17th March 1959

By a Deed of Grant of this date the within named William Neville Whittingham granted to the Ministry of Transport and Civil Aviation an easement for a 12 in Storm Water Drain at Bramham-cum-Oglethorpe in the County of York and he acknowledged the right of the Ministry to production of copies of the within written Conveyance and undertook for the safe custody thereof.

18th October  
1962.

By a Deed of Grant the within named William Neville Whittingham granted to the Minister of Transport an Easement for an 18" Storm Water Drain at Bramham-cum-Oglethorpe in the County of York and the Minister surrendered his right to the Easement for the 12" Storm Water Drain granted by the Deed of Grant dated the 17th March 1959 and the said William Neville Whittingham acknowledged the right of the Minister to production of copies of the Within written Conveyance and undertook for the safe custody thereof.

23 February 1967

BY CONVEYANCE of this date made between William Neville Whittingham of the first part James Bradshaw of the second part and Kenneth James Bradshaw of the third part ALL THAT piece of land in Back Lane Bramham AND ALSO ALL THOSE two cottages and outhouses appurtenant thereto erected thereon or on some part thereof and delineated on the plan attached thereto was conveyed to the said Kenneth James Bradshaw And an acknowledgment was therein given for the production of the within written Conveyance.

Extra Sale  
from Old Hall  
Estate(2)  
(1952 Conveyance)

MEMORANDUM that by a Conveyance made the Twelfth day of March One thousand nine hundred and seventy one a plot of land situate at the junction of New Road and Clifford Road Bramham having a frontage to Clifford Road of 960 ft. and an average depth of 188 ft. containing by admeasurement an area of 3.8 acres conveyed to Cam-bridge Limited for an estate in fee simple and an acknowledgment was given for production of and delivery of copies of the within written Conveyance

MEMORANDUM that by a Conveyance made the 12th day of May 1976 an irregular shaped plot of land fronting to Back Lane Bramham situate on the Westerly side of the Old Bungalow was conveyed to Auckley Homes Limited for an estate in fee simple and an acknowledgment was given for production of and delivery of copies of the within written Deed

MEMORANDUM that by a Conveyance dated the 1st day of March 1976 there was conveyed by Ruth Whittingham and Roger Whitley Suddards the Executors of the within named William Neville Whittingham unto The Leigh Mills Company Limited premises known as The Old Hall Bramham in the County of West Yorkshire for an estate in fee simple and an acknowledgment was given for the production of and delivery of copies of the within written Deed

MEMORANDUM that by a Conveyance dated the 12th June 1980 the personal representatives of W N Whittingham deceased conveyed unto Ian Leslie Westwood and Jennifer Elizabeth Hill All That cottage situate and known as Fine Garth Back Lane Bramham together with the land thereto adjoining for an estate in fee simple

Plot Sales

from Old Hall Estate (2)

(1952 Conveyance)

MEMORANDUM that by a Conveyance made the Twelfth day of March One thousand nine hundred and seventy one a plot of land situate at the junction of New Road and Clifford Road Bramham having a frontage to Clifford Road of 960 ft. and an average depth of 168 ft. containing by admeasurement an area of 3.8 acres conveyed to Cambridge Limited for an estate in fee simple and an acknowledgment was given for production of and delivery of copies of the within written Conveyance

MEMORANDUM that by a Conveyance made the 10th day of May 1971 an irregular shaped plot of land fronting to Back Lane Bramham situate on the western side of the Old Dingle and conveyed to Audley Homes Limited for an estate in fee simple and an acknowledgment was given for production of and delivery of copies of the within written Deed

MEMORANDUM that by a Conveyance dated the 1st day of March 1976 there was conveyed by Ruth Whittingham and Roger Whitley Suddards the Executors of the within named William Neville Whittingham unto The Leigh Mills Company Limited premises known as The Old Hall Bramham in the County of West Yorkshire for an estate in fee simple and an acknowledgment was given for the production of and delivery of copies of the within written Deed

MEMORANDUM that by a Conveyance dated the 12th June 1980 the personal representatives of W N Whittingham deceased conveyed unto Ian Leslie Westwood and Jennifer Elizabeth Hill All That cottage situate and known as Fine Garth Back Lane Bramham together with the land thereto adjoining for an estate in fee simple